

PHANTOM 2 VISION

QUICK START GUIDE

Learn More : www.dji.com

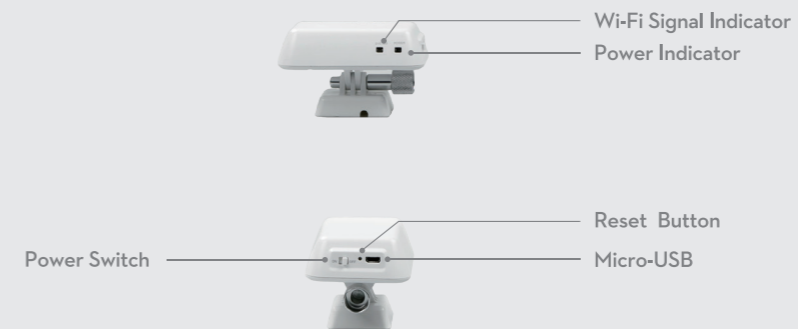

Basic Flight Operations

◀ Forward Direction (Indicates Front Side)

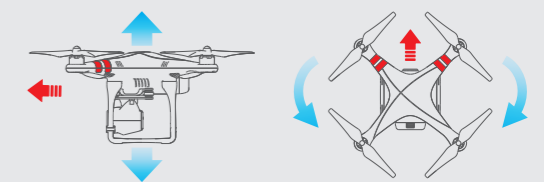

Left Stick

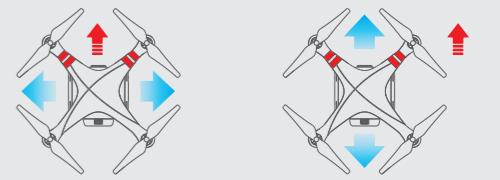

Right Stick



PHANTOM 2 VISION

QUICK START GUIDE

0

Scan QR Code to Watch the Quick Start Video or browse direct to www.dji.com/phantom2vision/training



Preparing to fly



How to connect to the DJI VISION App



The basics of flying, recording and sharing

ATTENTION: For SAFETY reasons and for further flight instruction, it is advised that you watch the videos above in full before attempting to use the Phantom.

1

ATTACHING THE PROPELLERS

- > Remove the four warning cards from the motors.
- > Screw the propellers, clockwise for grey nuts and anti-clockwise for black nuts, onto the four motors. Be sure to match the black propeller nuts with the black dot motors.

ATTENTION: DO NOT use thread lock on the propeller shafts.



2

PHONE HOLDER & RANGE EXTENDER

- > Install the Philips screws as shown to correctly attach the Phone Holder.
- > Install the Range Extender as shown.

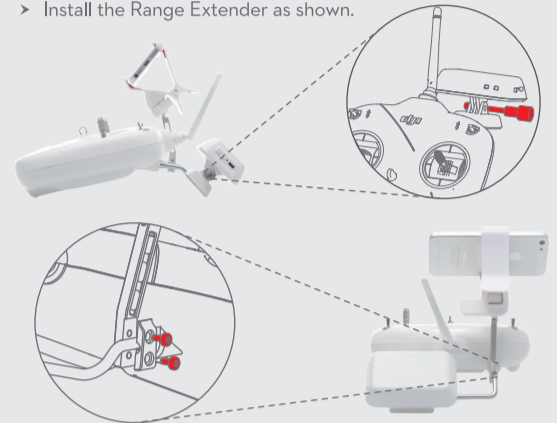

3

PREPARING THE REMOTE CONTROLLER

- > Be sure S1 and S2 are switched to the upper most position.
- > Install 4 x AA batteries into the back of the Remote Controller.

ATTENTION: A continuous beeping sound emitted from the Remote Controller indicates LOW BATTERY VOLTAGE.



4

SWITCHING ON THE RANGE EXTENDER

- > Before flying, be sure to switch on the Range Extender.

ATTENTION: If the power indicator on the Range Extender displays red, it means that there is LOW BATTERY power and needs to be recharged. To avoid this in the future, it is suggested that you charge the Range Extender fully before every use.



5

PREPARING THE CAMERA

- > Make sure the switch is on the "Wi-Fi ON" position.
- > Insert a micro SD card.



6

INSTALLING THE DJI VISION APP

- > To install the DJI VISION App onto your mobile phone, either download from the Apple App Store or the Google Play Store.
- > You can also use the QR Code below to scan and download.
- > Once installed, start the App and register.



Scan QR Code above



7

TURNING THE FLIGHT BATTERY ON/OFF

- > Press the circular button once, then press and hold for 2 seconds to turn on the flight battery.
- > Press the circular button once, then press and hold for 2 seconds to turn off the flight battery.

ATTENTION: Pressing the circular button once with no further action will indicate current BATTERY LEVEL.



8

LED FLIGHT INDICATORS

- > Slow green flashing indicates ready to fly with GPS.
- > Slow yellow flashing indicates ready to fly without GPS.
- > Fast yellow flashing indicates your Remote Controller is switched off.
- > Fast red flashing indicates low flight battery level.
- > Please refer to the card attached to the Remote Controller for more details.



9

CONNECTING TO THE CAMERA

- > First switch on the Range Extender before activating the Phantom 2 Vision.
- > Be sure Wi-Fi on your mobile device is switched on.
- > Connect to the SSID Phantom_1XXXXX, which should appear in your Wi-Fi signals list approx. 30 seconds after both the Range Extender and Phantom 2 Vision are powered on.

ATTENTION: ALWAYS connect to the SSID Phantom_1XXXXX. FC200_0XXXXX is the SSID of the Camera and SHOULD NOT be connected to.



10

CALIBRATING THE COMPASS

- > Rapidly flip the S1 switch from the 'fully up' to the 'fully down' positions for at least 10 times.
- > Once the LED Flight Indicators change to display solid yellow, the compass calibration mode has been initiated.
- > Holding the Phantom horizontally, rotate it 360° on its center axis until the LED Flight Indicators switch to solid green.
- > Then while holding the Phantom vertically, rotate 360° on its center axis until the LED Flight Indicators light disappears.

ATTENTION: If the LED Flight Indicators flash between yellow and red, then the process has FAILED. You must start over and repeat the previous steps until the process is successful.



11

BEGINNING YOUR FIRST FLIGHT

- > Start by placing the Phantom 2 Vision on the ground with the Battery Life Indicator lights facing yourself.
- > Switch on the Remote Controller.
- > Turn on the flight battery.
- > If you wish to use your mobile phone, be sure that you are connected to the Phantom 2 Vision via the App.
- > Pull both sticks on the remote controller to bottom corners as shown to start/stop the motors.
- > Start flying.

ATTENTION: ONLY stop the motors after the Phantom 2 Vision has landed, DO NOT stop the motors during flight!



Start/Stop Motors

